



3 Hope Street, Scarborough, YO12 7PR
£850 PCM

This three storey, three bedroomed terrace house is conveniently located for the Town Centre and North Bay. The property benefits from gas central heating and uPVC double glazing. At the front there is a forecourt and an enclosed yard at the rear. The property comprises a lounge, kitchen, family bathroom and three bedrooms one with an en-suite.

Children accepted, a pet will be considered. Sorry strictly no smoking.

EPC Rating: D

FRONT DOOR

leading to

TOTAL £1635.00

LOUNGE/DINER

with a bay window and radiator

KITCHEN

with a range of base and wall units, integrated oven and hob with extractor over, stainless steel sink unit, tiled splashback, plumbing for washing machine, space for fridge, radiator, window and door leading to the rear

UPSTAIRS TO

BEDROOM ONE

with window and radiator

BEDROOM TWO

with window and radiator

BATHROOM

with white three piece suite, radiator and window

UPSTAIRS TO

BEDROOM THREE

with window and radiator

EN-SUITE

with WC, vanity hand basin, shower cubicle radiator and window

DIRECTIONS

SATNAV - postcode YO12 7PR
what3words - ///status.both.shuts

UTILITIES

COUNCIL TAX - Band B (North Yorkshire Council)
GAS AND ELECTRIC CHARGES - TBC
WATER CHARGES - TBC

REFERENCING

TO APPLY WE REQUIRE PHOTO ID, PROOF OF INCOME, PROOF OF ADDRESS AND A HOLDING DEPOSIT OF £195.00 (PLEASE NOTE: THIS WILL BE WITHHELD IF ANY RELEVANT PERSON (INCLUDING ANY GUARANTORS) WITHDRAW FROM THE TENANCY, FAIL A RIGHT TO RENT CHECK, PROVIDE MATERIALLY SIGNIFICANT FALSE OR MISLEADING INFORMATION, OR FAIL TO SIGN THEIR TENANCY AGREEMENT (AND/OR GUARANTOR AGREEMENT) WITHIN 15 CALENDAR DAYS (OR OTHER DEADLINE FOR AGREEMENT AS MUTUALLY AGREED IN WRITING).

AFTER PASSING THE RENT AND DEPOSIT DUE ON THE DAY OF SIGNING THE AGREEMENTS ARE:

RENT £850.00

HOLDING DEPOSIT -£195.00

DEPOSIT £980.00

Floor Plan

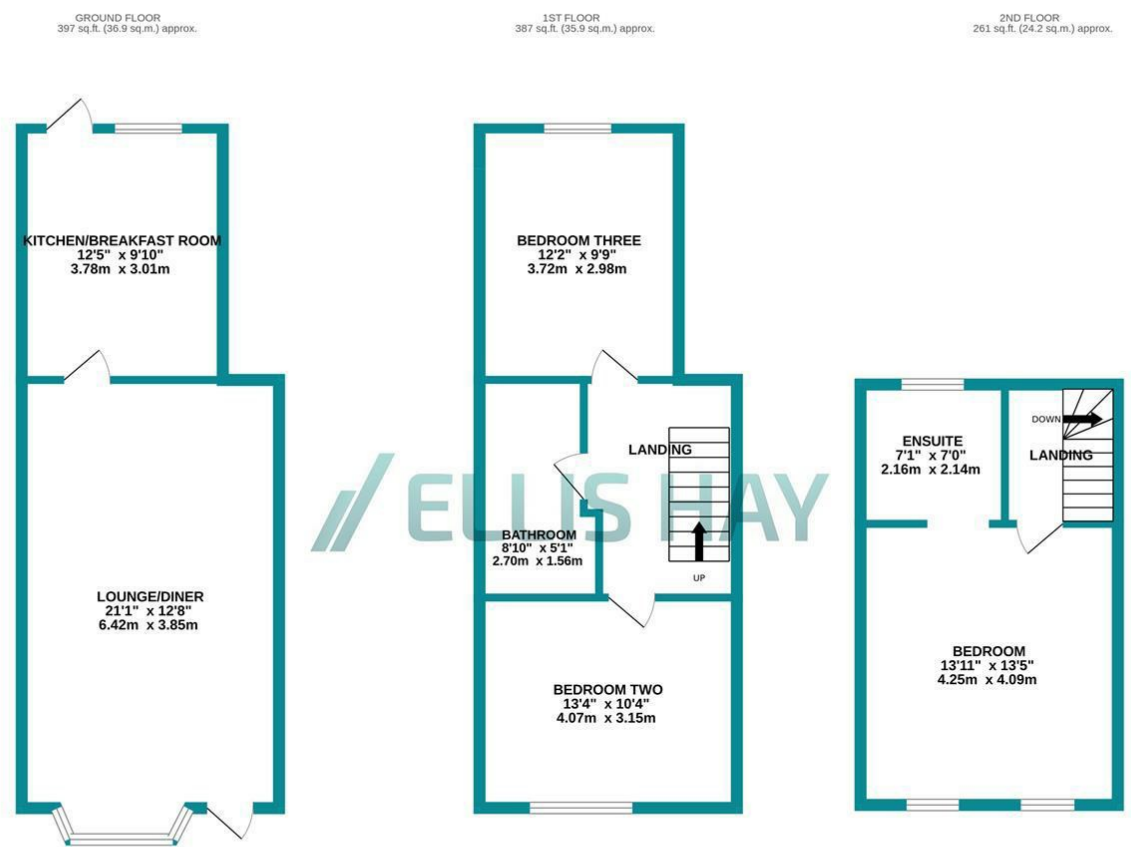

TOTAL FLOOR AREA : 1045 sq.ft. (97.1 sq.m.) approx.

Whilst every attempt has been made to ensure the accuracy of the floorplan contained here, measurements of doors, windows, rooms and any other items are approximate and no responsibility is taken for any error, omission or mis-statement. This plan is for illustrative purposes only and should be used as such by any prospective purchaser. The services, systems and appliances shown have not been tested and no guarantee as to their operability or efficiency can be given.

Made with Metropix ©2025

Area Map

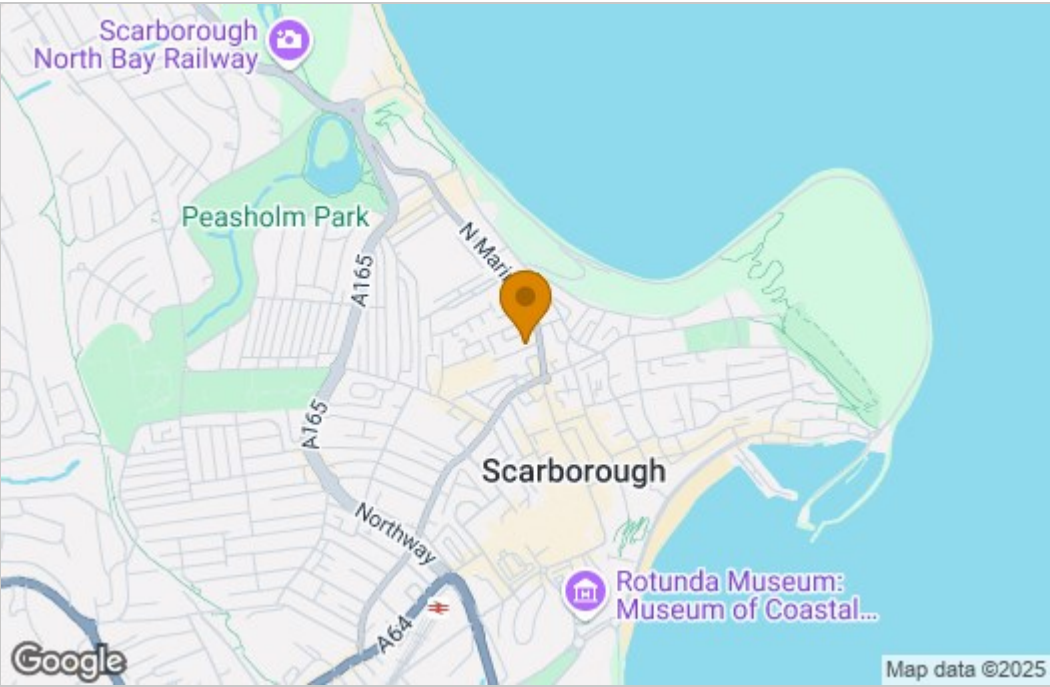

Energy Efficiency

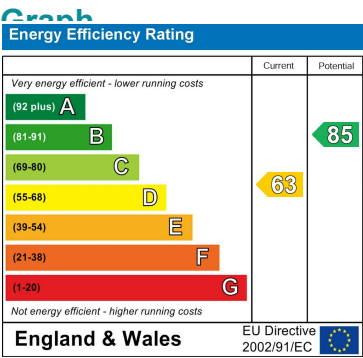

These particulars, whilst believed to be accurate are set out as a general outline only for guidance and do not constitute any part of an offer or contract. Intending purchasers should not rely on them as statements of representation of fact, but must satisfy themselves by inspection or otherwise as to their accuracy. No person in this firms employment has the authority to make or give any representation or warranty in respect of the property.